



2022

Slavia

PRODUCTION OF STAMPED AUTOMOTIVE COMPONENTS
AND STAMPED METAL PARTS

TOGLIATTI

LLC «Slavia» is a young, dynamically developing company. It is automotive components supplier since 2014.

The main business of the company is **production of automotive components and other metal parts by cold sheet-metal stamping** in the presses with tonnage from 40t up to 250t. The thickness of stamped sheet is up to 5mm.

In addition, **spot welding, arc welding, TIG welding and powder painting** is being developed for in-house needs.

The company provides full scope of services from **stamping tooling design and development involving outsourced traditional toolmakers** with further part validation up to **mass production**.

The company **guarantees top quality** of services provided at the level of latest global standards.

LLC «Slavia» production site is located in **Togliatti**, subdistrict **Povolzhsky** in a 80-km distance from regional capital – Samara and in a 50-km distance from international airport Kurumoch.

Samara region has a favorable geographical position. It is located on **transport intersections** connecting the West and the East of Russia, Ural, the South regions and the North of Russia.

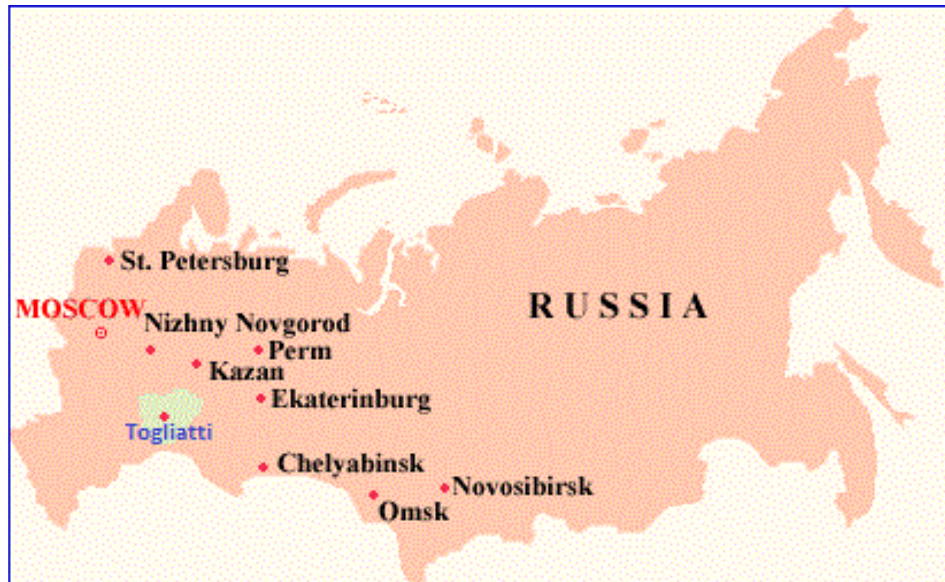

OUR TEAM



LLC «Slavia» Team is a group of high qualified specialists, **professionals** with vast knowledge in stamped products area and **great experience** in production.



Continuous development of staff professional and personal qualities, **solidarity of the team** contributes to development of the company and development of new production technologies.



Combination of expertise and theoretical training of the specialists allows not only to do production preparation **fully meeting the customer expectations** but also successfully start up new projects in due time and with reasonable budget.

OUR KEY FACTS AND FIGURES



| | |
|----------------------------|--|
| Year of Foundation | 2014 |
| Total Plant Area | 31 940 sq.m. (Slavia owned) |
| Employees | 32 |
| Blue Collars/White Collars | 22/10 |
| Working Hours | 12/7 (Stamping, welding) 8/5 (Powder Painting) |
| Equipment Tonnage | from 40 to 250 t |
| Technologies | Sheet Stamping, Spot-/Arc- TIG Welding Powder Painting |
| Forecasted Sales in 2022 | 25 mio RUB |

OUR PRODUCTION SITE

Total plat area 31 940 sq.m

Stamping and Welding 1 000 sq.m

Assembly 600 sq.m

Painting 350 sq.m

Tool shop 300 sq.m

Offices 600 sq.m

Warehouses 500 sq.m



PRODUCTION PROCESS



OUR PRODUCT PORTFOLIO



OUR CUSTOMERS



Despite its young age Slavia has managed to reach and maintain reputation of **Reliable Supplier** of high-quality metal parts.

The main customers are different suppliers of automotive components, including 1st Tier Suppliers of **APO (AVTOVAZ-Renault-Nissan)**, **VW**, **Ford**, as well as manufacturers in other industries such as **Bosch Power Tools**, **Haier**:

The HI-LEX logo, with 'HI-LEX' in a bold, blue, sans-serif font.

The ESTRA logo, featuring the word 'ESTRA' in a stylized font with blue and orange geometric shapes.

The MARTUR logo, with 'MARTUR' in a bold, black, sans-serif font and a small square icon to the right. Below it, 'Automotive Seating Systems' is written in a smaller, brown font.

The MAGNA logo, featuring a stylized black 'M' icon with a red dot above it, followed by the word 'MAGNA' in a bold, grey, sans-serif font.

The BOSCH logo, featuring a circular silver icon with a stylized 'H' inside, followed by the word 'BOSCH' in a bold, red, sans-serif font.

The CIMOS logo, featuring a red circular icon with a white stylized 'C' inside, followed by the word 'CIMOS' in a bold, red, sans-serif font.

The VW logo, featuring a stylized blue 'V' and 'W' in a bold, sans-serif font.

The Haier logo, with the word 'Haier' in a white, sans-serif font inside a blue rectangular box.

OUR CONTRIBUTION TO CAR PORTFOLIO



VW Taos



FORD Ecosport



NISSAN



RENAULT



LADA Granta



DATSUN



LADA 4x4



UAZ Patriot

- **Development** of stamping production taking into consideration market situation, competitiveness and risks for financial stability of the company:
 - **Medium term objective** by 2024 to expand the scope of equipment for small and medium part stamping up to **14 presses**.
 - **Long term objective** by 2028 to build up business cases sufficient for investments into presses for **big part stamping** – 2 presses over 250t.
- **Development of engineering capacities** of the company (own part design and development according to customer specifications).
- **Development of new technologies and processes** (automatic blanking, progressive and transfer stamping).
- **Production diversification.** Active project development of different commodities group and for non-automotive industries.

- **Part Design and Development** (outsourced engineering company)
(3D-and 2D-drawings)
- **Tooling Design and Development, Manufacture** - full technical management of these processes
- **Part validation** (local and foreign laboratories)
- **Part Production:**
 - Blank cut-to-size
 - Stamping (main process)
 - Welding (spot, arc, TIG)
 - Powder Painting for in-house parts (affiliated company)
- **Quality Assurance**
- **Just-in-time Deliveries**

OUR TECHNOLOGICAL CAPABILITIES

STAMPING:

Single Crank Press,
Tonnage from 40 to 250t



Double Crank Press,
Tonnage 100t, Working table up to
2000 mm



Hydraulic Press, Tonnage
250t



BLANKING AND WELDING:

Cut-to-size, metal
thickness up to 5 mm



Spot and projection
resistance welding

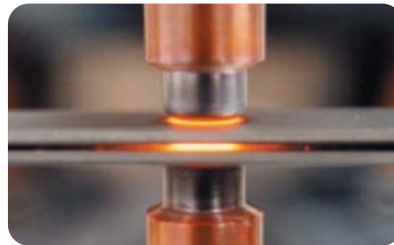

Arc welding



OUR TECHNOLOGICAL CAPABILITIES

POWDER PAINTING:

Equipment:

TW Gema®

Materials:



Characteristics reached by powder painting:

- **Coating thickness:** from 30 μm and higher;
- **Corrosion resistance:** up to 720 hr in salt fog.

Powder painted parts are tested for corrosion resistance at designated frequency in the outsourced lab (Togliatti State University).

OUR TOOLING

Considering complexity, designation of the product or customer specification stamping tooling or control jigs can be outsourced abroad (mostly in China) or locally.



In this case we do full tool management to ensure **100% part quality** manufactured by our equipment.

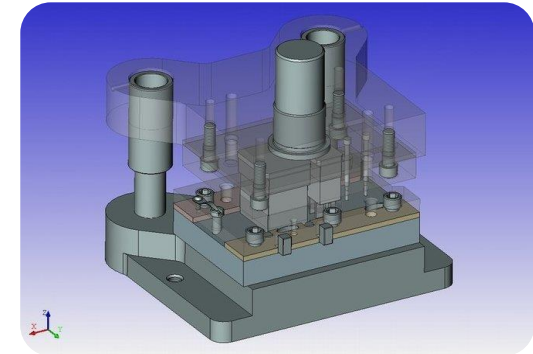

The company has a **tool maintenance area** where the tooling is maintained and repaired during whole project life.

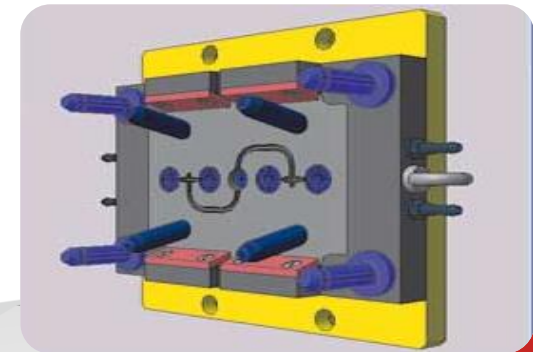

The essence of company strategy is **customer priority**, service quality improvement and utmost attention to all the processes on all project phases.

We focus on the functioning and improvement of the quality management system. The QMS of Slavia LLC was certified for compliance with the requirements of ISO 9001:2015 in April 2022.

Our company ensures **process approach** at all stages of production.

We ensure **individual approach** to each customer based on accurate study of requirements to quality and their strict fulfillment.

The results of our customers recent audits: Magna (VDA 6.3) – B rank, «Estra» (IATF 16949) – B rank, Bosch PT (VDA 6.3) – B rank.



СЕРТИФИКАТ

Настоящим удостоверяется, что система менеджмента качества

ООО «Славия»

ул. Октябрьская, 104, п. Тимофеевка, Ставропольский район,
Самарская область, 445140, Российская Федерация

была проверена и признана соответствующей требованиям стандарта:

ISO 9001:2015

Сертификат действителен в отношении следующей области деятельности:

Производство штампованных изделий и сборочных узлов из металла, с применением контактной, дуговой и аргоновой сварки

Сертификат №: RU96288A

| <u>Дата первоначальной регистрации:</u> | <u>Дата сертификата:</u> | <u>Надзорный аудит до: / истечения срока действия сертификата:</u> | <u>Срок повторной сертификации:</u> |
|---|--------------------------|--|-------------------------------------|
| 28 апреля 2022 | 28 апреля 2022 | 27 апреля 2023 | 27 апреля 2025 |

Действительность сертификата зависит от успешного завершения надзорного аудита в установленный срок или раньше.
В случае, если надзорный аудит не был проведен, действие сертификата приостанавливается/аннулируется.



Директор



For verification and updated information concerning the present certificate visit to www.lmscert.com
This Certificate is the property of LMS Certification Limited and shall be returned immediately when demanded.



LMS Certifications Limited
Labrynth Business Centre, 43 Middle Hill Gate, Stockport,
Great Manchester, England-SK1 3DG
Phone: +44 208 935 5094
Company No.: 11029176
Visit > www.lmscert.com
E-mail > info@lmscert.com

LMS/FM/001/Q/REV06



CERTIFICATE

This is to Certify that the Management System of

LLC Slavia

set. 104, Octyabrskaya Street, Timofeyevka, Stavropolsky District,
Samara Region, 445140, Russian Federation

has been audited and found to comply with the requirements of:

ISO 9001:2015 (Quality Management System)

For the Scope of activities described below:

**Production of stamped products and metal assemblies,
using contact, arc and TIG welding.**

Certificate No.: RU96288A

| <u>Date of initial registration</u> | <u>Date of this Certificate</u> | <u>Surv. audit on or before/ Certificate expiry</u> | <u>Recertification Due</u> |
|-------------------------------------|---------------------------------|---|----------------------------|
| 28 April 2022 | 28 April 2022 | 27 April 2023 | 27 April 2025 |

Validity of this certificate is subject to successful completion of surveillance audit on or before due date,
in case surveillance audit not conducted this certificate shall be suspended/cancelled.



Director



For verification and updated information concerning the present certificate visit to www.lmscert.com
This Certificate is the property of LMS Certification Limited and shall be returned immediately when demanded.



LMS Certifications Limited
Labrynth Business Centre, 43 Middle Hill Gate, Stockport,
Great Manchester, England-SK1 3DG
Phone: +44 208 935 5094
Company No.: 11029176
Visit > www.lmscert.com
E-mail > info@lmscert.com

LMS/FM/001/Q/REV06

OUR 10 KEY ADVANTAGES



Complete scope of services from tooling design development and further part and process validation up to mass production.



Application of all standard and special methods and quality tools (8D, 5Why, QRQC).



SOP in accordance with milestones of customer timings.



Trouble free logistics. Own trucks.



Design and development, manufacture and repair of stamping tooling.



Successful projects start-ups with 1st Tier Suppliers.



Pricing transparency. Co-investment with the customer in the project.



Customer orientation.
Individual approach.
Loyalty.



Process approach on all stages of the project as per ISO 9001:2015 (APQP, FMEA, PPAP, MSA, SPC).



Reliable supplier reputation

Legal Address:

445131, Russian Federation, Samara Region, Stavropolsky District, Uzyukovo set., Povolzhskoye Schosse Bld.4/1



Production Address:

445131, Russian Federation, Samara Region, Stavropolsky District, Uzyukovo set., Povolzhskoye Schosse Bld.4/1

Postal Address:

445044, Russian Federation, Samara Region, Togliatti, PO Box 101

Telephone: +7 (8482) 743-000; +7 (8482) 411-313

E-mail: info@slaviagroup.ru

Website: www.slaviagroup.ru